

# Patnubay sa pagakses ng Canvas

1. Gumamit ng Google Chrome bilang browser ng Canvas.
2. Pumunta sa [www.google.com](http://www.google.com) at itype sa search bar ang: Canvas.

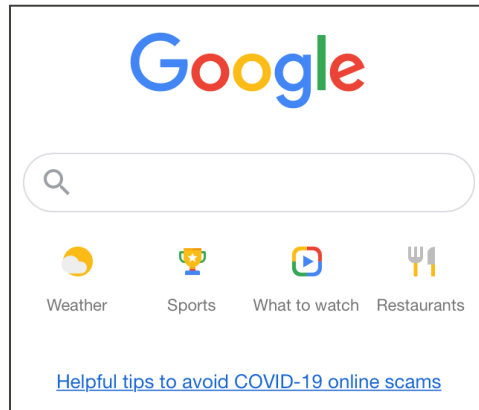

3. Gamitin ang link na ipinapakita bilang "Canvas by Instructure."

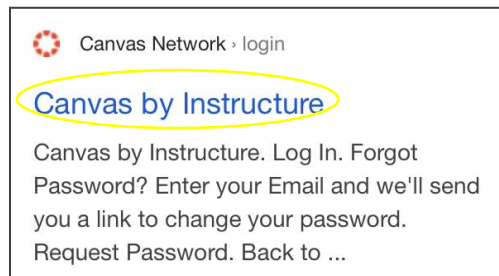

4. Ilagay ang iyong email address at password, at piliin ang: Maglog in.

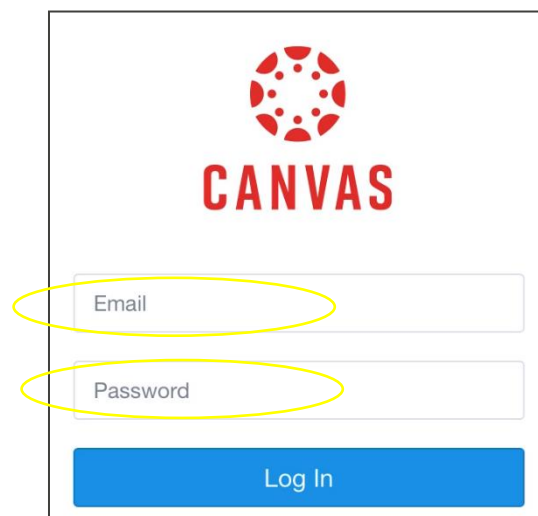

5. Ito ay dadalhin ka sa Dashboard.



6. Upang makakuha ng Parent Code at maglogin bilang Tagasubaybay ng iyong anak, pumunta sa:

a) Piliin: Account.

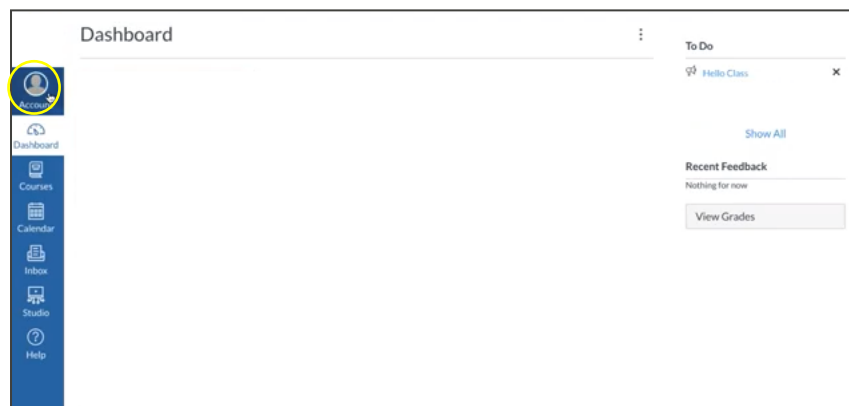

b) Piliin: Settings:

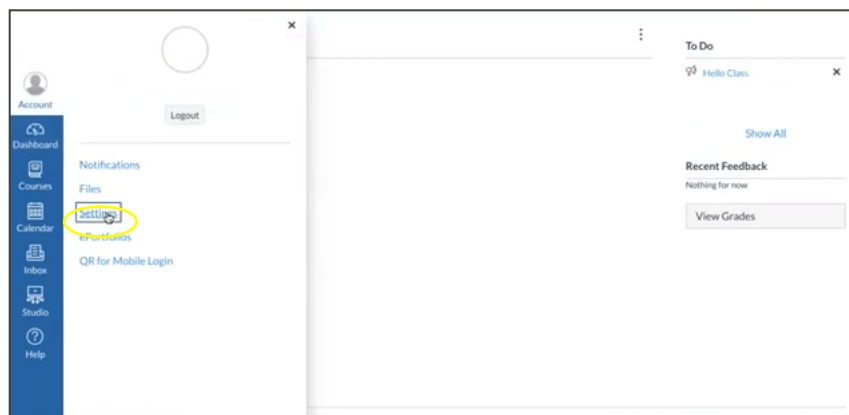

c) Piliin: Pumareha sa tagasubaybay.

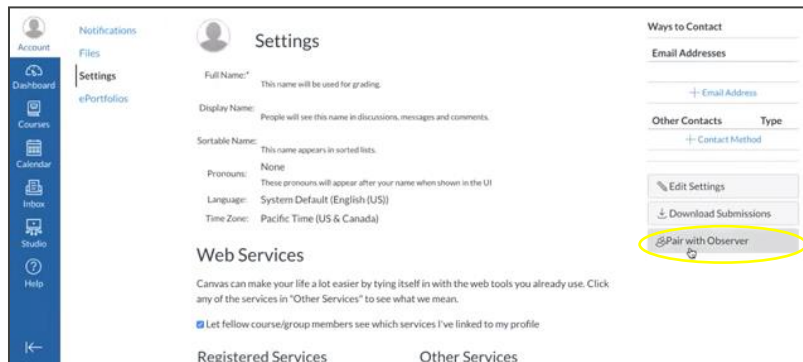

d) I-save ang **STUDENT PAIRING CODE**.

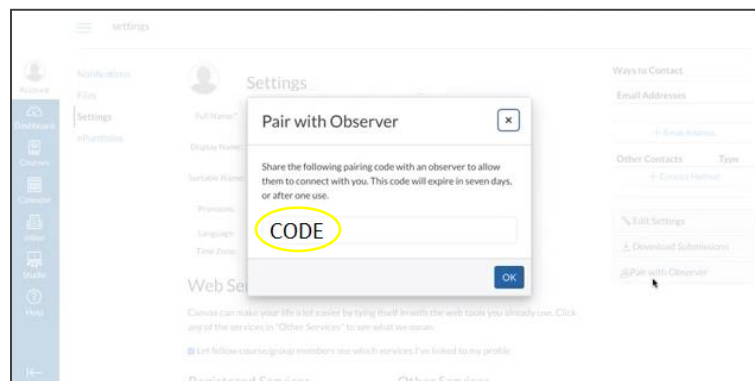

**GUMAWA NG CANVAS ACCOUNT BILANG MAGULANG:** Ang akses sa Canvas ng magulang ay pinamamalaan ng paaralan. Kakailanganin ang Canvas URL na ibinigay ng paaralan kung saan nagpatala. Makipagugnayan sa paaralan para Canvas URL.

Pagsign-up ng magulang:

1. Ilagay ang iyong impormasyon. Gamitin ang **STUDENT PAIRING CODE** na ibinahagi saiyo, at pumunta sa "START PARTICIPATING"

A screenshot of the 'Parent Signup' form. The title 'Parent Signup' is circled in yellow. The form contains several input fields: 'Your Name', 'Your Email', 'Password', and 'Re-enter Password'. At the bottom, there is a 'Student Pairing Code' field with a blue link 'What is a pairing code?' next to it.

2. Maglogin bilang magulang/tagasubaybay. Ilagay ang email ay password.

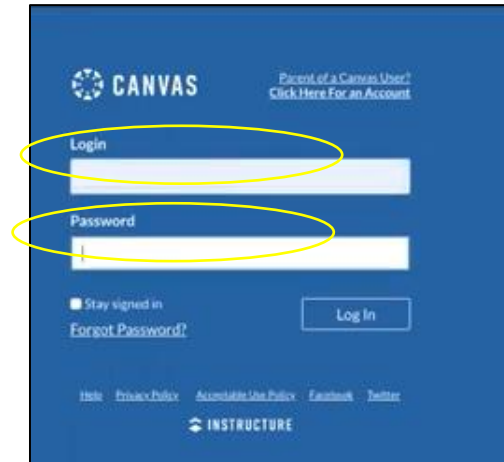

3. Ikaw ay dadalhin sa dashboard ng iyong anak bilang tagasubaybay.

